

# BUTTERFLY

## table of area

ground floor

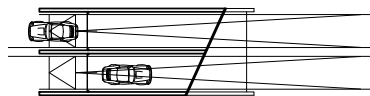
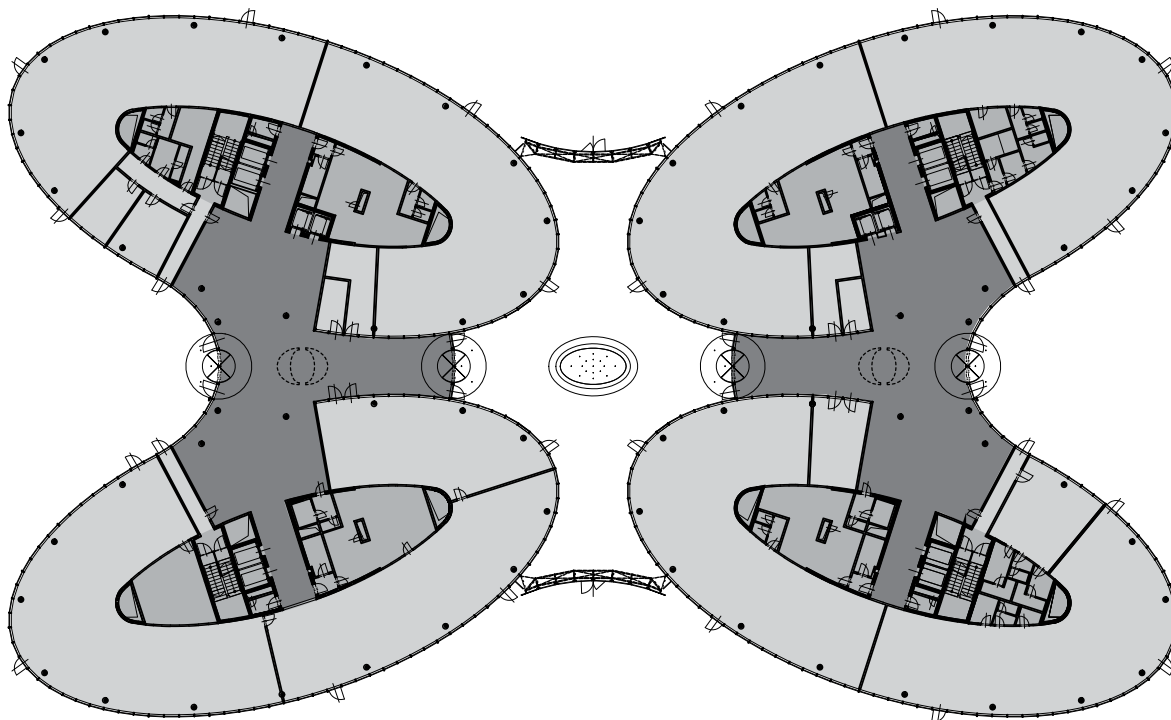

- retail space / obchodní plochy
- lobby / recepcie

### BUILDING / BUDOVA - A

### BUILDING / BUDOVA - B

floors / patra	offices kanceláře	lobby / WC lobby / toalety	retail space obchodní plochy	restaurant / cafe restaurace / café	offices kanceláře	lobby / WC lobby / toalety	retail space obchodní plochy	storage sklady	TOTAL
5 <sup>th</sup> floor / 5. patro	414	25	-	-	414	25	-	-	878
4 <sup>th</sup> floor / 4. patro	1 985	145	-	-	1 985	145	-	-	4 261
3 <sup>rd</sup> floor / 3. patro	1 985	145	-	-	1 985	145	-	-	4 261
2 <sup>nd</sup> floor / 2. patro	1 985	145	-	-	1 985	145	-	-	4 261
1 <sup>st</sup> floor / 1. patro	1 985	145	-	-	1 985	145	-	-	4 261
ground floor / přízemí	-	548	698	807	-	549	1 442	-	4 044
basement / suterén	-	-	-	-	-	-	-	1 138	1 138
<b>TOTAL</b>	<b>8 355</b>	<b>1 155</b>	<b>698</b>	<b>807</b>	<b>8 355</b>	<b>1 156</b>	<b>1 442</b>	<b>1 138</b>	<b>23 105</b>

[www.butterfly-karlin.cz](http://www.butterfly-karlin.cz)

AFI EUROPE Czech Republic, Jankovcova 1037/49, Praha 7, 170 00 Czech Republic

+420 255743 111, [www.afi-europe.eu](http://www.afi-europe.eu)

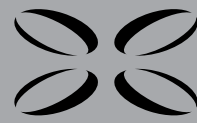

# BUTTERFLY

typical floor plan

